



## ET..M type directional solenoid valve - 4 way / 3 positions

- Direct acting
- Spool type
- From SAE08 to SAE10 cavities

Technical specifications and diagrams are measured with mineral oil of 46 cSt viscosity at 40°C (104°F) temperature.

	ET08M	ET10M
Nominal flow	18 l/min (4.7 US gpm)	40 l/min (10.5 US gpm)
Max. pressure	210 bar (3050 psi)	
Oil leakage	at 210 bar (3050 psi) 40 cm <sup>3</sup> /min (2.44 in <sup>3</sup> /min)	80 cm <sup>3</sup> /min (4.88 in <sup>3</sup> /min)
Fluid	mineral based oil	
Viscosity	10-200 cSt	
Max level of contamination	18/16/13 ISO4406	
Fluid temperature	with NBR seals with FPM seals	from -20°C (-4°F) to 80°C (176°F) from -20°C (-4°F) to 100°C (212°F)
Environmental temp. for working conditions	from -20°C (-4°F) to 50°C (122°F)	
Cavity	SAE 08/4	SAE 10/4
Coils type*	BER	BC
Nominal voltages	12 VDC - 24 VDC ± 10%	12 VDC - 24 VDC ± 10%
Power rating	22.8 W (12 VDC) - 22.5 W (24 VDC)	26.1 W (12 VDC) - 25.9 W (24 VDC)
Weight	0.25 kg (0.44 lb)	0.45 kg (1.10 lb)

NOTE - For different conditions, please contact Walvoil Sales Dpt. - \*For coils further features see from page 206.

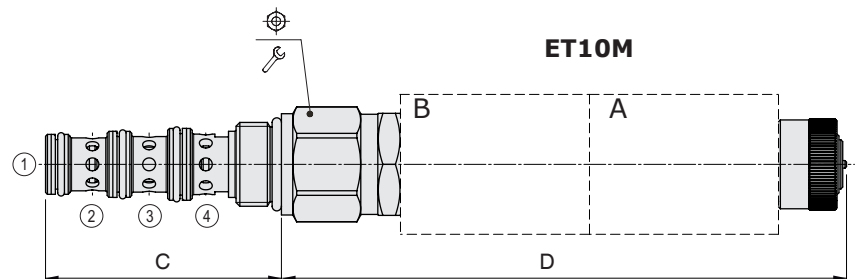
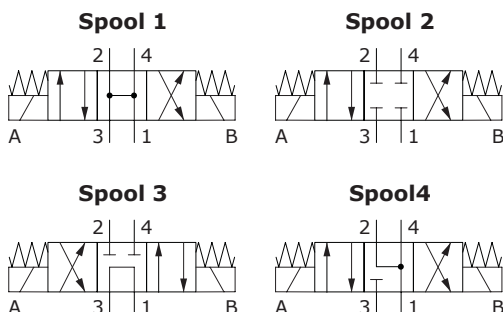

Valve type	C		D			
	mm	in	mm	in		
ET08M/..NB	53.6	2.11	120	4.72	24	30 22
ET10M/..NB	62.4	2.46	148.5	5.85	27	50 37

For dimensions with different type of emergency see page 213

### Ordering codes and description composition

ET08M/10 NB

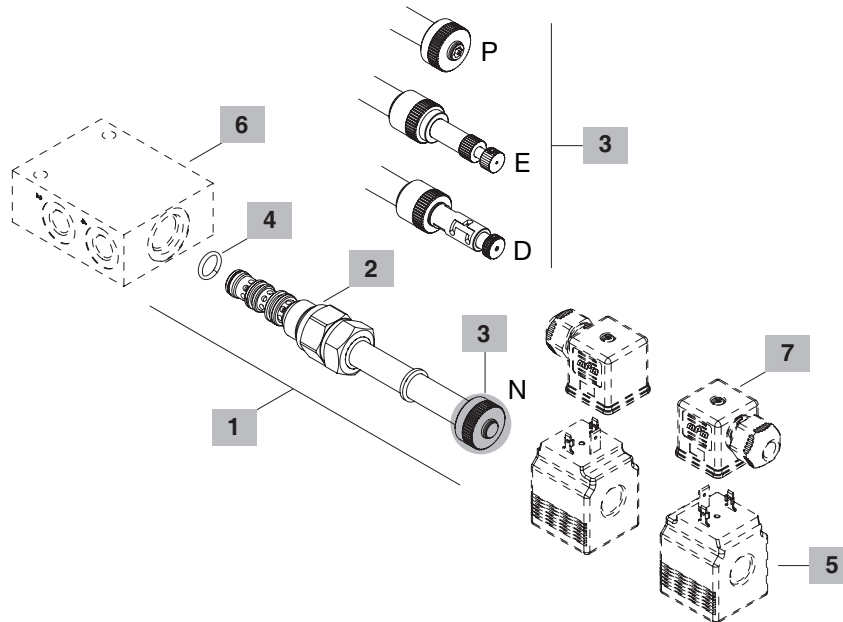
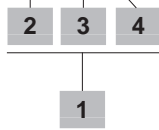

#### 1 Cartridges

TYPE	CODE	DESCRIPTION
<b>SAE cavity 08/4</b>		
<b>ET08M/10NB</b>	0ET08002017	Without emergency, spool 1
<b>ET08M/20NB</b>	0ET08002019	Without emergency, spool 2
<b>ET08M/30NB</b>	0ET08002020	Without emergency, spool 3
<b>ET08M/40NB</b>	0ER08002018	Without emergency, spool 4
<b>SAE cavity 10/4</b>		
<b>ET10M/10NB</b>	0ET10002023	Without emergency, spool 1
<b>ET10M/20NB</b>	0ET10002024	Without emergency, spool 2
<b>ET10M/30NB</b>	0ET10002025	Without emergency, spool 3
<b>ET10M/40NB</b>	0ET10002026	Without emergency, spool 4

#### 2 Spool

TYPE	DESCRIPTION
<b>1</b>	Spool 1
<b>2</b>	Spool 2
<b>3</b>	Spool 3
<b>4</b>	Spool 4

#### 3 Emergency

TYPE	DESCRIPTION
<b>N</b>	Without emergency
<b>E</b>	Pull/push-button type
<b>D</b>	Detent push/pull type
<b>P</b>	Push-button type

#### 4 Seals

TYPE	DESCRIPTION
<b>B</b>	<b>NBR (Buna)</b> o-ring seals, std configuration
<b>V</b>	<b>FPM (Viton)</b> o-ring seals, contact Sales Dept.

#### 5 Coils

TYPE	CODE	DESCRIPTION
<b>BER 12VDC</b>	4SLE001200	12VDC-ISO4400 coil for ET08M
<b>BC 12VDC</b>	4SL8000120	12VDC-ISO4400 coil for ET10M

For complete coils list see from page 206

#### 6 Valve body

TYPE	CODE	DESCRIPTION
<b>SAE 08/4-G 3/8</b>	3CC0840C11	Aluminium body for cavity 08 valve, G 3/8 std thread
<b>SAE 10/4-G 3/8</b>	3CC1040C11	Aluminium body for cavity 10 valve, G 3/8 std thread

For steel bodies or different threading see from page 219

#### 7 Connector

TYPE	CODE	DESCRIPTION
<b>ISO4400</b>	4CN1009995	Connector

For complete connectors list see from page 206

# Directional control valves

Directional solenoid valves - 4 way / 3 positions

**ET..M type**

## Rating diagrams

**ET08M pressure drop vs. flow**  
- Spool 1 -

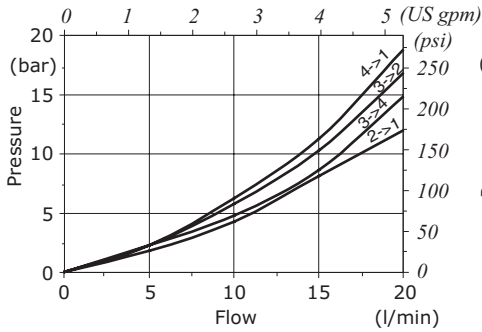

**ET08M pressure drop vs. flow**  
- Spool 2 -

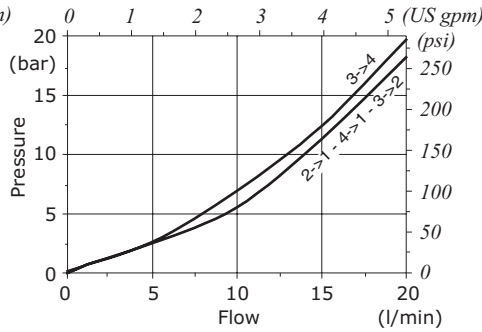

**ET08M pressure drop vs. flow**  
- Spool 3 -

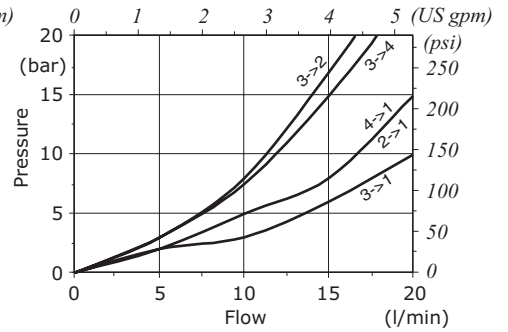

**ET08M pressure drop vs. flow**  
- Spool 4 -

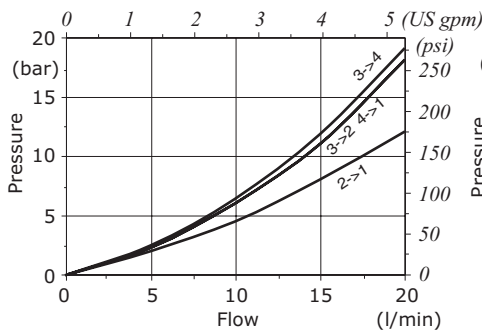

**ET08M performance limit**

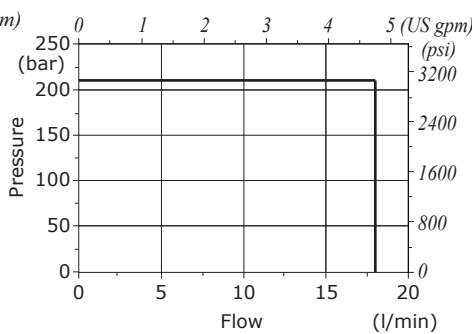

**ET10M pressure drop vs. flow**  
- Spool 1 -

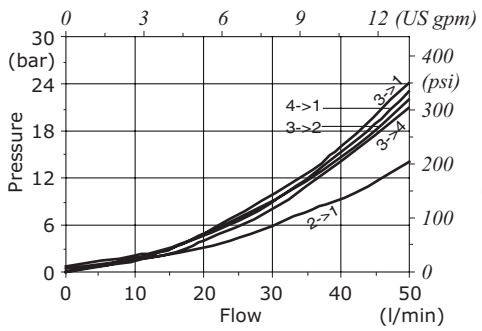

**ET10M pressure drop vs. flow**  
- Spool 2 -

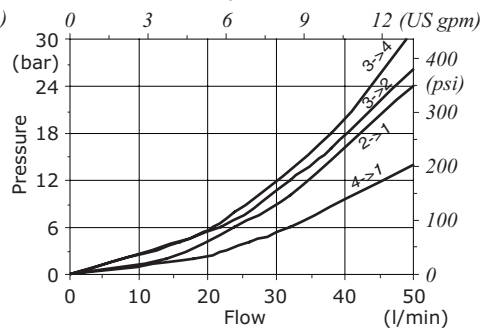

**ET10M pressure drop vs. flow**  
- Spool 3 -

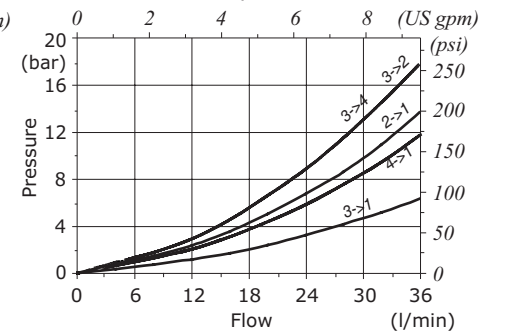

**ET10M pressure drop vs. flow**  
- Spool 4 -

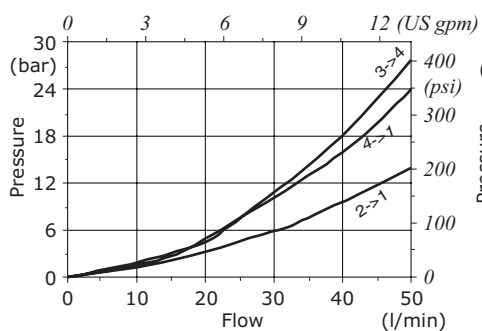

**ET10M performance limit**

