



## Type VUI check valves

- Poppet type

Technical specifications and diagrams are measured with mineral oil of 46 cSt viscosity at 40°C (104°F) temperature.

	<b>VUI 38</b>	<b>VUI 38/HF</b>	<b>VUI 12</b>	<b>VUI 34</b>	<b>VUI 100</b>
Nominal flow	25 l/min (6.6 US gpm)	40 l/min (10.6 US gpm)	40 l/min (10.6 US gpm)	100 l/min (26.4 US gpm)	160 l/min (42.3 US gpm)
Max. pressure	400 bar (5800 psi)	300 bar (4350 psi)	400 bar (5800 psi)	400 bar (5800 psi)	400 bar (5800 psi)
Oil leakage	0.25 cm <sup>3</sup> /min (0.015 in <sup>3</sup> /min) at 210 bar (3050 psi)				
Fluid	mineral based oil				
Viscosity	from 10 to 200 cSt				
Max. level of contamination	18/16/13 ISO4406				
Fluid temperature	with NBR seals: from -20°C (-4°F) to 80°C (176°F)				
Environmental temperature for working conditions	from -40°C (-40°F) to 100°C (212°F)				
Weight	Steel 0.08 kg (0.18 lb)	0.075 kg (0.16 lb)	0.15 kg (0.33 lb)	0.30 kg (0.66 lb)	0.54 kg (1.19 lb)

NOTE - For different conditions, please contact Walvoil Sales Dpt.



Dimensions

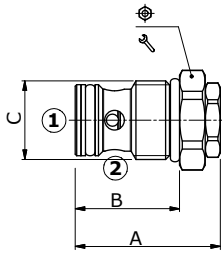

Dimensions are in mm-in

Valve type	A	B	C	$\varnothing$	Nm-lbft
VUI 38	42-1.65	27-1.06	M20x1.5	24	40-29
VUI 38/HF	34.5 - 1.36	28 - 1.10	M22x1.5	27	50-37
VUI 12	48-1.89	34.5-1.36	M26x1.5	30	60-44
VUI 34	68-2.68	51-2.01	M33x2	38	70-51
VUI 100	75-2.95	54.5-2.14	M42x2	46	80-59

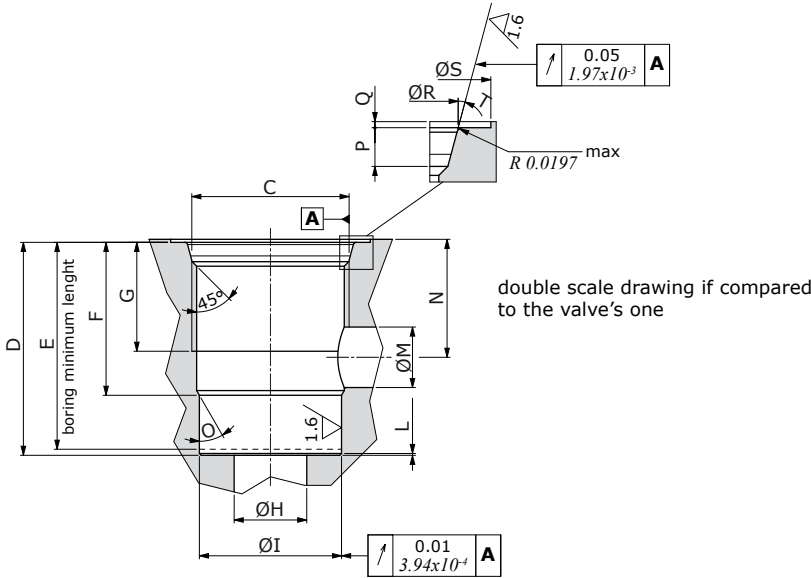

Dimensions are in mm-in

Valve cavity for	C	D	E	F	G	$\varnothing$ H	$\varnothing$ I	L	$\varnothing$ M	N	O	P	Q	$\varnothing$ R	$\varnothing$ S
VUI 38	M20x1.5	29.5 1.16	28 1.10	20.5 0.81	16 0.63	10 0.39	16 H9 0.630 H9	/	7 0.275	16 0.63	30°	3 0.118	0.5 0.020	21 0.83	30 1.18
VUI 12	M26x1.5	35.2 1.39	34.2 1.35	25.3 0.996	18 0.71	12 0.47	23.5 H9 0.925 H9	0.3x45° 0.012x45°	10 0.39	19.5 0.77	30°	3.2 0.126	0.5 0.020	27.6 1.09	33 1.30
VUI 34	M33x2	52.5 2.07	51.5 2.03	39 1.54	28 1.10	20 0.79	27 H9 1.063 H9	0.5x45° 0.020x45	15 0.59	29.5 1.16	20°	3.2 0.126	0.5 0.020	34 1.35	40 1.57
VUI 100	75-2.95	57 2.24	55 2.17	41 1.61	29 1.14	28 1.10	38 H9 1.496 H9	1.5x45° 0.059x45	18 0.71	30 1.18	30°	4.5 0.177	0.5 0.020	43.5 1.71	50 1.97

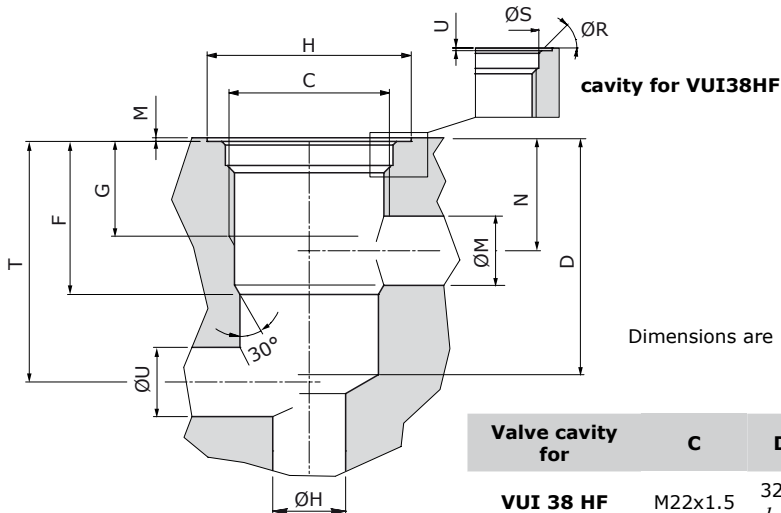

Valve cavity for	C	D	F	G	$\varnothing$ H	$\varnothing$ M	N	T	$\varnothing$ U
VUI 38 HF	M22x1.5	32.5 1.28	21 0.83	15 0.59	max. 18 max. 0.71	max.9 max. 0.35	15.5 0.61	33 1.30	9.5 0.37

**Ordering codes and description composition**

**VUI 38/Pa0,5**

**1**

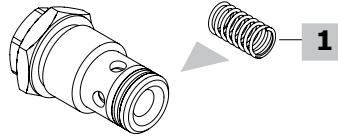

**VUI complete valves**

TYPE	CODE	DESCRIPTION
<b>VUI 38/Pa0,5</b>	1300020400	Steel body, opening pressure 0.5 bar (7.25 psi)
<b>VUI 38/HF/Pa0,5</b>	1300020900	Steel body, opening pressure 0.5 bar (7.25 psi)
<b>VUI 12/Pa0,5</b>	1300030400	Steel body, opening pressure 0.5 bar (7.25 psi)
<b>VUI 34/Pa0,5</b>	1300040400	Steel body, opening pressure 0.5 bar (7.25 psi)
<b>VUI 100/Pa0,5</b>	1300050400	Steel body, opening pressure 0.5 bar (7.25 psi)

For configurations with FPM (Viton) seals please contact our Sales Dpt.

**1 Pressure setting springs**

TYPE	CODE	DESCRIPTION
<b>For VUI 38 valve</b>		
<b>Pa0,5</b>	3ML1072001	Opening pressure 0.5 bar (7.25 psi)
<b>Pa5</b>	3ML1072003	Opening pressure 5 bar (72.5 psi)
<b>For VUI 38 HF valve</b>		
<b>Pa0,5</b>	1300020900	Opening pressure 0.5 bar (7.25 psi)
<b>For VUI 12 valve</b>		
<b>Pa0,5</b>	3ML1112900	Opening pressure 0.5 bar (7.25 psi)
<b>Pa5</b>	3ML1102801	Opening pressure 5 bar (72.5 psi)
<b>For VUI 34 valve</b>		
<b>Pa0,5</b>	3ML1155200	Opening pressure 0.5 bar (7.25 psi)
<b>Pa5</b>	3ML1155000	Opening pressure 5 bar (72.5 psi)
<b>For VUI 100 valve</b>		
<b>Pa0,5</b>	3ML1172801	Opening pressure 0.5 bar (7.25 psi)
<b>Pa5</b>	3ML1172800	Opening pressure 5 bar (72.5 psi)

**Rating diagrams**

**VUI 38 pressure drop vs. flow**

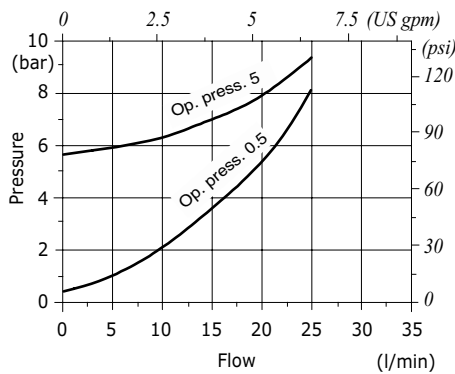

**VUI 38 HF pressure drop vs. flow**

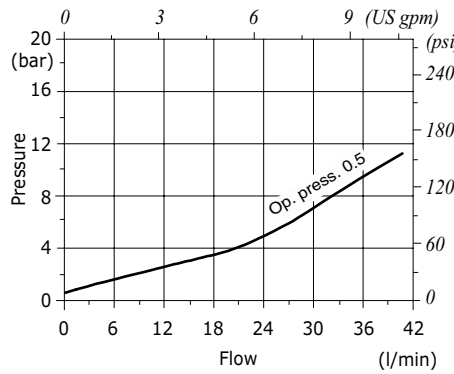

**VUI 12 pressure drop vs. flow**

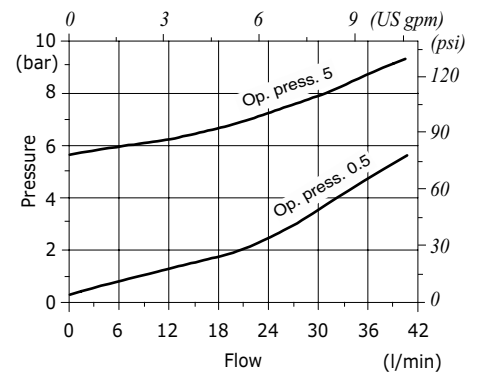

**VUI 34 pressure drop vs. flow**

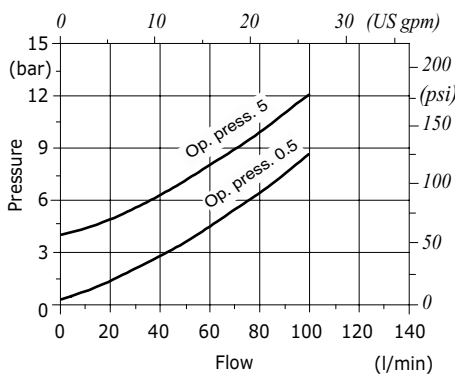

**VUI 100 pressure drop vs. flow**

