



EK10L type directional solenoid valves – 5 way / 3 positions

- Spool type
- Direct acting with proportional solenoid
- Different types of emergencies available
- External zinc-plated and corrosion-proof components

Technical specifications and diagrams are measured with mineral oil of 46 cSt viscosity at 40°C (104°F) temperature.

		EK10L
Nominal flow		20 l/min (5.3 US gpm)
Max. pressure		250 bar (3600 psi)
Oil leakage	at 210 bar (3050 psi)	80 cm ³ /min (4.88 in ³ /min)
Fluid		mineral based or synthetic hydraulic fluid with lubricating properties
Viscosity		10-200 cSt
Max level of contamination		18/16/13 ISO4406
Fluid temperature	with NBR seals+Polyurethane with FPM seals	from -25°C (-13°F) to 90°C (194°F) from -20°C (-4°F) to 110°C (230°F)
Environmental temp. for working conditions		from -20°C (-4°F) to 60°C (140°F)
Cavity		SAE 10/5
Coil type*		BC
Nominal voltages		12VDC - 24 VDC ± 10%
Power rating		26 W (12VDC - 24VDC)
Weight		0.720 kg (1.59 lb)

NOTE - For different conditions, please contact Walvoil Sales Dpt. - *For coils further features see from page 201.
- (²) Port 1 may be fully pressurized, it's not intended for use as the valve's inlet.

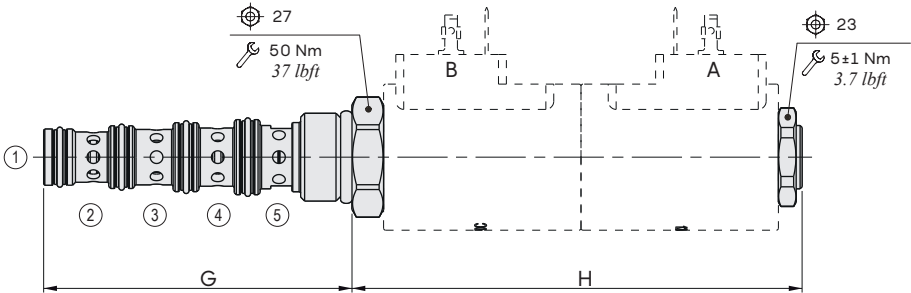
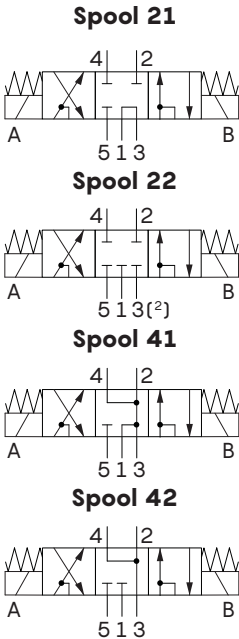

Valve type	G		N without emergency		D push type with detent		E with pull/push button	
	mm	in	mm	in	mm	in	mm	in
EK10L	78.1	3.07	114	4.49	142	5.59	142	5.59

Ordering codes and description composition

EK10L/22 0 N B

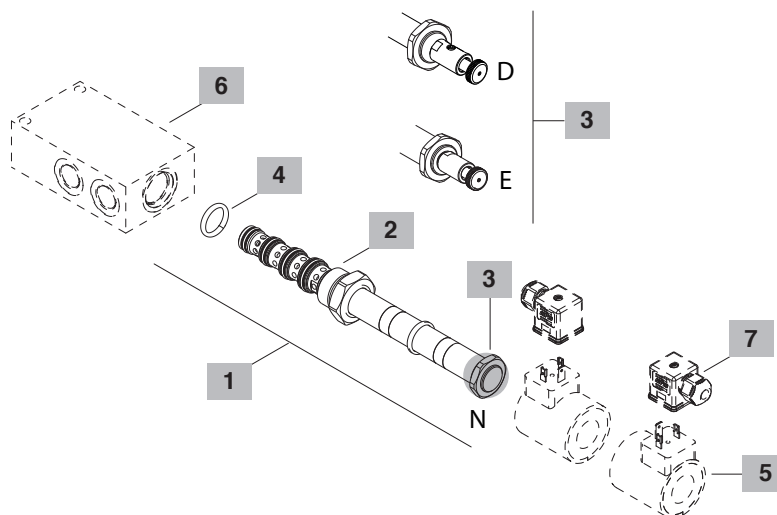
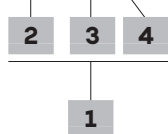

1 Cartridges

TYPE	CODE	DESCRIPTION
SAE cavity 10/5		
EK10L/210NB	OEK10002003	Without emergency, spool 21
EK10L/220NB	OEK10002000	Without emergency, spool 22
EK10L/410NB	OEK10002001	Without emergency, spool 41
EK10L/420NB	OEK10002004	Without emergency, spool 42

2 Spool

TYPE	DESCRIPTION
21	Spool 21
22	Spool 22
41	Spool 41
42	Spool 42

3 Emergency

TYPE	DESCRIPTION
N	Without emergency
D	Push/pull type with detent
E	Push/pull type without detent

4 Seals

TYPE	DESCRIPTION
B	NBR (Buna)+Polyurethane o-ring seals, std configuration
V	FPM (Viton) o-ring seals, contact Sales Dept

5 Coils

TYPE	CODE	DESCRIPTION
BC12VDC	4SL8000120	12VDC-ISO4400 coil

For complete coils list see page 201

6 Valve body

TYPE	CODE	DESCRIPTION
SAE10/5-G 3/8	3CC1050C11	Aluminium body for cavity 10 valve, G 3/8 std thread

Note: aluminium body can stand up to 210 bar (3050 psi)
For steel bodies or different threading see from page 214

7 Connector

TYPE	CODE	DESCRIPTION
ISO4400	4CN1009995B	Connector

For complete connectors list see from page 201

Rating diagrams

EK10L pressure drop vs. flow
 spool 21

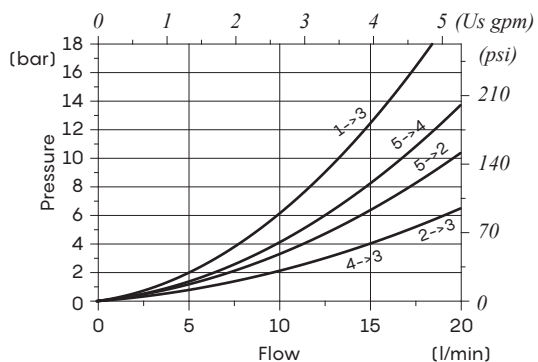

EK10L pressure drop vs. flow
 spool 22

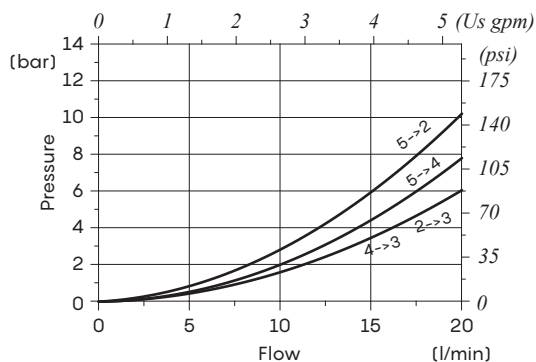

EK10L pressure drop vs. flow
 spool 41

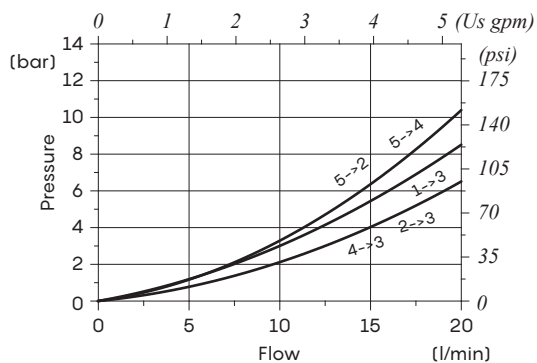

EK10L pressure drop vs. flow
 spool 42

